

# ESOTERIC

K-05

## Super Audio CD/CD Player

OWNER'S MANUAL





# IMPORTANT SAFETY PRECAUTIONS (1)



**CAUTION**  
RISK OF ELECTRIC SHOCK  
DO NOT OPEN



CAUTION: TO REDUCE THE RISK OF ELECTRIC SHOCK, DO NOT REMOVE COVER (OR BACK). NO USER-SERVICEABLE PARTS INSIDE. REFER SERVICING TO QUALIFIED SERVICE PERSONNEL.



The lightning flash with arrowhead symbol, within an equilateral triangle, is intended to alert the user to the presence of uninsulated "dangerous voltage" within the product's enclosure that may be of sufficient magnitude to constitute a risk of electric shock to persons.



The exclamation point within an equilateral triangle is intended to alert the user to the presence of important operating and maintenance (servicing) instructions in the literature accompanying the appliance.

WARNING: TO PREVENT FIRE OR SHOCK HAZARD, DO NOT EXPOSE THIS APPLIANCE TO RAIN OR MOISTURE.

## CAUTION

- DO NOT REMOVE THE EXTERNAL CASES OR CABINETS TO EXPOSE THE ELECTRONICS. NO USER SERVICEABLE PARTS ARE INSIDE.
- IF YOU ARE EXPERIENCING PROBLEMS WITH THIS PRODUCT, CONTACT TEAC FOR A SERVICE REFERRAL. DO NOT USE THE PRODUCT UNTIL IT HAS BEEN REPAIRED.
- USE OF CONTROLS OR ADJUSTMENTS OR PERFORMANCE OF PROCEDURES OTHER THAN THOSE SPECIFIED HEREIN MAY RESULT IN HAZARDOUS RADIATION EXPOSURE.

**IN NORTH AMERICA USE ONLY ON 120 V SUPPLY.**

## For U.S.A.

This equipment has been tested and found to comply with the limits for a Class B digital device, pursuant to Part 15 of the FCC Rules. These limits are designed to provide reasonable protection against harmful interference in a residential installation. This equipment generates, uses, and can radiate radio frequency energy and, if not installed and used in accordance with the instructions, may cause harmful interference to radio communications. However, there is no guarantee that interference will not occur in a particular installation. If this equipment does cause harmful interference to radio or television reception, which can be determined by turning the equipment off and on, the user is encouraged to try to correct the interference by one or more of the following measures:

- Reorient or relocate the equipment and/or the receiving antenna.
- Increase the separation between the equipment and receiver.
- Connect the equipment into an outlet on a circuit different from that to which the receiver is connected.
- Consult the dealer or an experienced radio/TV technician for help.

## CAUTION

Changes or modifications to this equipment not expressly approved by TEAC CORPORATION for compliance will void the user's warranty.

## For Canada

Industry Canada's Compliance Statement:

This Class B digital apparatus complies with Canadian ICES-003.

Cet appareil numérique de la classe B est conforme à la norme NMB-003 du Canada.

## China RoHS (电子信息产品污染控制管理办法)

- The information in the following table is only applicable to products for sale in the People's Republic of China.
- The products sold in the European area are manufactured in accordance with the European RoHS Directive.

产品有毒有害物质或元素的名称及含量

机种: K-05		有毒有害物质或元素					
品名	铅 (Pb)	汞 (Hg)	镉 (Cd)	六价铬 (Cr (VI))	多溴联苯 (PBB)	多溴二苯醚 (PBDE)	
1 CHASSIS部份	×	○	○	○	○	○	
2 PANEL部份	○	○	○	○	○	○	
3 FOOT部份	○	○	○	○	○	○	
4 螺丝部份	○	○	○	○	○	○	
5 PCB Assy部份	×	○	○	○	○	○	
6 线材部份	○	○	○	○	○	○	
7 SEAL部份	○	○	○	○	○	○	
8 AC CORD部份	×	○	○	○	○	○	
9 附属品部份	○	○	○	○	○	○	
10 包装部份	○	○	○	○	○	○	

○: 表示该有毒有害物质在该部件所有均质材料中的含有量均在 SJ/T11363-2006 标准规定的限量要求以下。

×: 表示该有毒有害物质至少在该部件的某一均质材料中的含量超出 SJ/T11363-2006 标准规定的限量要求。

(针对现在代替技术困难的电子部品及合金中的铅)

## IMPORTANT SAFETY PRECAUTIONS (2)

This product has been designed and manufactured according to FDA regulations "title 21, CFR, chapter 1, subchapter J, based on the Radiation Control for Health and Safety Act of 1968", and is classified as class I laser product. There is not hazardous invisible laser radiation during operation because invisible laser radiation emitted inside of this product is completely confined in the protective housings.

The label required in this regulation is as follows:

For U.S.A.

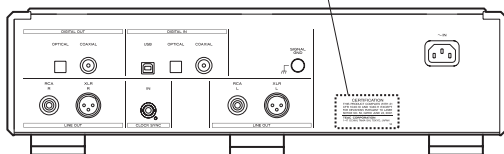

### Laser :

Type	: SLD6163RL-G
Manufacturer	: SONY CORPORATION
Laser output	: Less than 1mW on the objective lens
Wavelength	: 785±15 nm (CD) 655±10 nm (Super Audio CD)

### ⚠ Precautions concerning batteries

Misuse of batteries could cause them to rupture or leak leading to fire, injury or the staining of nearby things. Please read and observe the following precautions carefully.

- Be sure to insert the batteries with correct positive (⊕) and negative (⊖) orientations.
- Use batteries of the same type. Never use different types of batteries together.
- If the remote control is not used for a long time (more than a month), remove the batteries to prevent them from leaking.
- If the batteries leak, wipe away the leakage inside the battery compartment and replace the batteries with new ones.
- Do not use batteries of types other than those specified. Do not mix new batteries with old ones or use different types of batteries together.
- Do not heat or disassemble batteries. Never throw batteries into fire or water.
- Do not carry or store batteries with other metallic objects. The batteries could short circuit, leak or explode.
- Never recharge a battery unless it is confirmed to be a rechargeable type.

"DSD" is a registered trademark.

"Super Audio CD" is a registered trademark.

Microsoft, Windows XP, Windows Vista and Windows 7 are either registered trademarks or trademarks of Microsoft Corporation in the United States and/or other countries.

Apple, Macintosh and Mac OS X are trademarks of Apple Inc., registered in the U.S. and other countries.

Other company names, product names and logos in this document are the trademarks or registered trademarks of their respective owners.

## IMPORTANT SAFETY INSTRUCTIONS

- 1) Read these instructions.
- 2) Keep these instructions.
- 3) Heed all warnings.
- 4) Follow all instructions.
- 5) Do not use this apparatus near water.
- 6) Clean only with dry cloth.
- 7) Do not block any ventilation openings. Install in accordance with the manufacturer's instructions.
- 8) Do not install near any heat sources such as radiators, heat registers, stoves, or other apparatus (including amplifiers) that produce heat.
- 9) Do not defeat the safety purpose of the polarized or grounding-type plug. A polarized plug has two blades with one wider than the other. A grounding type plug has two blades and a third grounding prong. The wide blade or the third prong are provided for your safety. If the provided plug does not fit into your outlet, consult an electrician for replacement of the obsolete outlet.
- 10) Protect the power cord from being walked on or pinched particularly at plugs, convenience receptacles, and the point where they exit from the apparatus.
- 11) Only use attachments/accessories specified by the manufacturer.
- 12) Use only with the cart, stand, tripod, bracket, or table specified by the manufacturer, or sold with the apparatus. When a cart is used, use caution when moving the cart/apparatus combination to avoid injury from tip-over.



- 13) Unplug this apparatus during lightning storms or when unused for long periods of time.
  - 14) Refer all servicing to qualified service personnel. Servicing is required when the apparatus has been damaged in any way, such as power-supply cord or plug is damaged, liquid has been spilled or objects have fallen into the apparatus, the apparatus has been exposed to rain or moisture, does not operate normally, or has been dropped.
- The apparatus draws nominal non-operating power from the AC outlet with its POWER or STANDBY/ON switch not in the ON position.
  - The mains plug is used as the disconnect device, the disconnect device shall remain readily operable.
  - Caution should be taken when using earphones or headphones with the product because excessive sound pressure (volume) from earphones or headphones can cause hearing loss.

### CAUTION

- Do not expose this apparatus to drips or splashes.
- Do not place any objects filled with liquids, such as vases, on the apparatus.
- Do not install this apparatus in a confined space such as a book case or similar unit.
- The apparatus should be located close enough to the AC outlet so that you can easily reach the power cord plug at any time.
- If the product uses batteries (including a battery pack or installed batteries), they should not be exposed to sunshine, fire or excessive heat.
- CAUTION for products that use replaceable lithium batteries: there is danger of explosion if a battery is replaced with an incorrect type of battery. Replace only with the same or equivalent type.

### WARNING

Products with Class I construction are equipped with a power supply cord that has a grounding plug. The cord of such a product must be plugged into an AC outlet that has a protective grounding connection.

## For European Customers

### Disposal of electrical and electronic equipment

- (a) All electrical and electronic equipment should be disposed of separately from the municipal waste stream via collection facilities designated by the government or local authorities.
- (b) By disposing of electrical and electronic equipment correctly, you will help save valuable resources and prevent any potential negative effects on human health and the environment.
- (c) Improper disposal of waste electrical and electronic equipment can have serious effects on the environment and human health because of the presence of hazardous substances in the equipment.
- (d) The Waste Electrical and Electronic Equipment (WEEE) symbol, which shows a wheeled bin that has been crossed out, indicates that electrical and electronic equipment must be collected and disposed of  separately from household waste.
- (e) Return and collection systems are available to end users. For more detailed information about the disposal of old electrical and electronic equipment, please contact your city office, waste disposal service or the shop where you purchased the equipment.

### Disposal of batteries and/or accumulators

- (a) Waste batteries and/or accumulators should be disposed of separately from the municipal waste stream via collection facilities designated by the government or local authorities.
- (b) By disposing of waste batteries and/or accumulators correctly, you will help save valuable resources and prevent any potential negative effects on human health and the environment.
- (c) Improper disposal of waste batteries and/or accumulators can have serious effects on the environment and human health because of the presence of hazardous substances in them.
- (d) The WEEE symbol, which shows a wheeled bin that has been crossed out, indicates that batteries and/or accumulators must be collected and disposed of  separately from household waste.  
**Pb, Hg, Cd**  
If a battery or accumulator contains more than the specified values of lead (Pb), mercury (Hg), and/or cadmium (Cd) as defined in the Battery Directive (2006/66/EC), then the chemical symbols for those elements will be indicated beneath the WEEE symbol.
- (e) Return and collection systems are available to end users. For more detailed information about the disposal of waste batteries and/or accumulators, please contact your city office, waste disposal service or the shop where you purchased them.

# Contents

**Thank you for choosing Esoteric. Read this manual carefully to get the best performance from this unit.**

What's in the box .....	6
Before use .....	7
Discs .....	7
Remote control unit .....	9
Making connections .....	10
Names and functions of parts (main unit) .....	12
Names and functions of parts (display) .....	13
Names and functions of parts (remote control) .....	14
Playback .....	16
Selecting tracks .....	18
Using repeat playback .....	19
Using program playback .....	19
Changing the display .....	21
D/A converter mode .....	21
Connecting a computer and playing back audio files .....	22
Setting mode .....	24
Using the dimmer .....	28
Adjusting the volume .....	29
Troubleshooting .....	29
Specifications .....	31
Rear panel .....	32

# What's in the box

Check to be sure the box includes all the supplied accessories shown below.

Please contact the store where you purchased this unit if any of these accessories are missing or have been damaged during transportation.

## Remote control unit (RC-1251) x 1



## Batteries (AA) x 2



## Power cord set x 1

## Owner's manual (this document) x 1

- Keep this manual in a safe place for future reference.

## Warranty card x 1

## Before use

Read this before attempting any operations.

### CAUTION

- Do not move the unit during playback.  
During playback, the disc rotates at high speed. Do not lift or move the unit during playback. Doing so may damage the disc or the unit.
- The voltage supplied to the unit should match the voltage as printed on the rear panel. If you are in any doubt regarding this matter, consult an electrician.
- Do not open the cabinet as this might result in damage to the circuitry or cause electric shock. If a foreign object should get into the unit, contact your dealer or service company.
- When removing the power plug from the wall outlet, always pull directly on the plug, never yank on the cord.
- Always remove the disc before relocating or moving this unit. Moving the unit with a disc inside could cause a malfunction.

### Maintenance

If the surface of the unit gets dirty, wipe it with a soft cloth or use diluted mild liquid soap. Allow the surface of the unit to dry completely before using.

- ⚠ For safety, disconnect the power cord from the socket before cleaning.
- Never spray liquid directly on this unit.
- Do not use thinner or alcohol as they could damage the surface of the unit.
- Avoid allowing rubber or plastic materials to touch this product for long periods of time, because they could damage the cabinet.

### Beware of condensation

When the unit is moved from a cold to a warm place, or used after a sudden temperature change, there is a danger of condensation on the lens of CD/SACD player. Vapor in the air could cause condensation on the internal mechanism, making proper operation impossible. If this occurs, or as a preventative measure, leave the unit turned on for one or two hours. This will allow the unit to adjust to the temperature of its surroundings.

## Discs (1)

### Discs that can be played on this unit

#### CDs that bear the "COMPACT disc DIGITAL AUDIO" logo.



- 12cm (4.7") or 8cm (3.15") discs
  - Linear PCM digital audio
- Audio CDs are divided into tracks.

#### Super Audio CDs that bear the "Super Audio CD" logo.



- Single layer, dual layer or hybrid layer
  - 12cm (4.7") discs
  - Digital audio (DSD)
- Super Audio CDs are divided into tracks.

#### CD-R and CD-RW discs that have been correctly recorded in the audio CD format (CD-DA) and finalized.

This unit can play these types of discs without an adapter. It cannot play any other type of disc.

⚠ Playback of any other disc type could result in an unpleasant loud noise, damage to the speakers as well as potential harm to your hearing. Never play back any other type of disc.

- The logo should be on the disc label or the CD jacket.
- DVDs, Video CDs, DVD-ROMs, CD-ROMs and similar types of discs cannot be played on this unit.
- Copy-protected discs and other discs that do not conform to the CD standard might not play correctly in this player. If you use such discs in this unit, ESOTERIC company and its subsidiaries will not be responsible for any consequences or guarantee the quality of reproduction. If you experience problems with such non-standard discs, you should contact their issuers.
- Discs created by a CD recorder must be finalized before use with this unit. If you are uncertain about the handling of a CD-R or CD-RW disc, please contact the seller of the disc directly.

Depending on disc quality and recording conditions, playback of some discs might not be possible. Please see the manual for the device that you used to create the disc.

## Discs (2)

### CAUTION

- Do not play any disc that is warped, deformed or damaged. Playing such discs could cause irreparable harm to the playing mechanisms.
- While printable CD-R and CD-RW discs utilizing modern printing technologies are generally acceptable, older systems that use adhesives to attach paper type labels to the disc surface are not recommended.
- Do not stick papers or protective sheets on the discs and do not use any protective coating sprays.
- Never use a stabilizer. Using commercially available CD stabilizers with this unit will damage the mechanisms and cause them to malfunction.
- Do not use irregularly-shaped discs (octagonal, heart-shaped, business-card-size, etc.). CDs with these shapes could damage the unit.

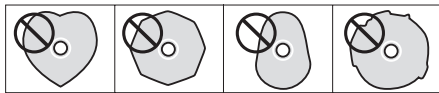

### Handling precautions

- Always insert the disc into the disc tray with the label side up. Only one side of a Compact Disc can be played or used for recording.
- To remove a disc from its storage case, press down on the center of the case and lift the disc out, holding it carefully by the edges.



How to remove the disc



How to hold the disc

### Storage precautions

- Discs should be returned to their cases after use to avoid dust and scratches that could cause the laser pickup to "skip."
- Do not expose discs to direct sunlight or high temperature and humidity for extended periods. Long exposure to high temperatures will warp discs.
- CD-R and CD-RW discs are more sensitive to the effects of heat and ultraviolet rays than ordinary CDs. It is important that they are not stored in locations where they will be exposed to direct sunlight. They should also be kept away from sources of heat, such as radiators and heat-generating electrical devices.

### Maintenance

- If a disc becomes dirty, wipe its surface radially from the center hole outward towards the outer edge with a soft, dry cloth.



- Never clean discs using chemicals such as record sprays, antistatic sprays and fluids, and thinner. Such chemicals will do irreparable damage to the disc's plastic surface.

If you are in any doubt as to the care and handling of a disc, read the precautions supplied with the disc or contact the disc manufacturer.

## Remote control unit

The included remote control allows this unit to be operated from a distance.

Point the remote control unit at the main unit's remote sensor within 23 feet/7 meters of the main unit.

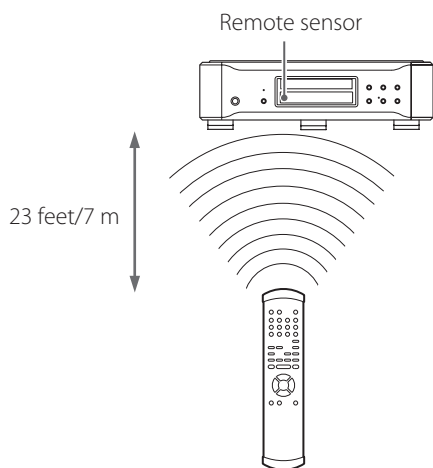

- Depending on the angle, reception might be difficult. Use the remote control from directly in front of the unit as much as possible.
- Even if the remote control unit is used within its effective range, operation by remote control might be impossible if there are any obstacles between the unit and the remote control.
- If direct sunlight or strong artificial illumination shines on the remote sensor, the remote control might not function.
- If the remote control unit is operated near other devices that generate infrared rays, or if other remote controls that use infrared rays are operated near the unit, this unit might operate incorrectly. The other devices might also operate incorrectly.

## Battery Installation

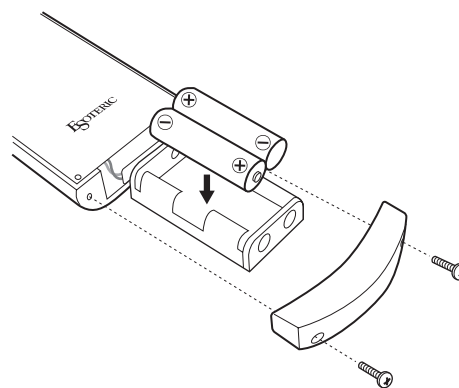

Use a Phillips screwdriver to remove the cover from the bottom of the remote control, and pull out the battery case. Insert two AA batteries with the correct  $\oplus/\ominus$  orientations, reinsert the case and close the cover.

## Battery Replacement

If the operating range required between the remote control unit and main unit decreases, the batteries are exhausted. In this case, replace the batteries with new ones.

For more information about collection of batteries, please contact your local government, your waste disposal service or the point of sale where you purchased the items.

# Making connections

## ⚠️ Precautions when making connections

- Make all connection before plugging in the power cord.
- Carefully read the operation manuals of the other equipment and follow their instructions when connecting them.

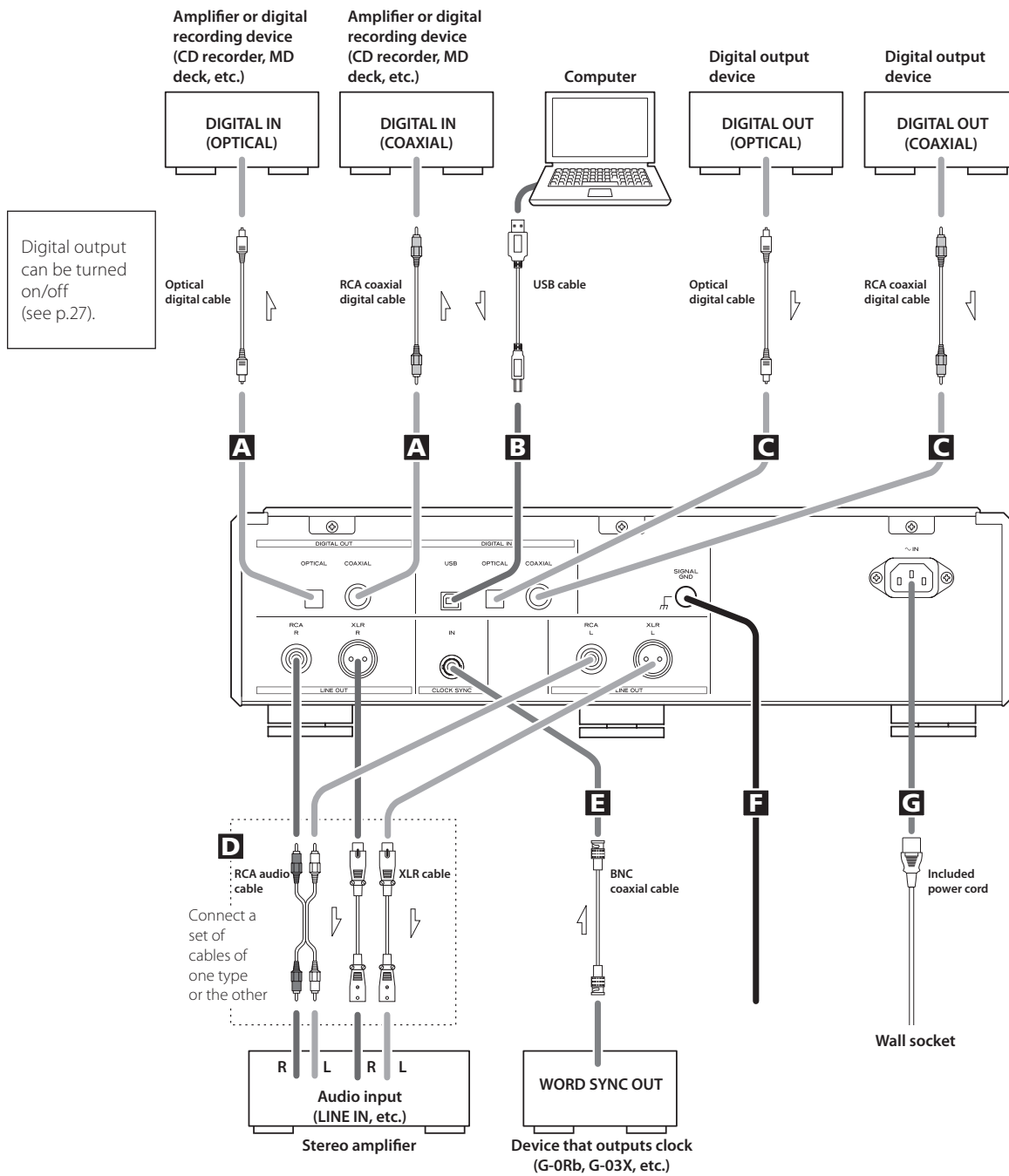

The polarity of the XLR connectors can be set so that either 2 or 3 is HOT (see p.27).

## A Digital audio output connectors

The DIGITAL OUTPUT connectors will send a digital audio signal from CDs played on this unit.

Connect a digital audio output connector (COAXIAL or OPTICAL) to the digital audio input connector of an amplifier or digital recording device (e.g. CD recorder).

### Use commercially available cables for connections.

COAXIAL: RCA digital cable

OPTICAL: optical digital cable (TOS)

- These connectors cannot output Super Audio CD digital audio.
- Digital output can be turned on or off (see p.27).

## B USB input connector

Used to input digital audio from a computer. Connect it to a computer USB connector.

Use a commercially available USB cable for connection.

- Before connecting, read the cautions on pages 22–23.

## C Digital audio input connectors

Used to input digital audio signals. They can be connected to the digital output connectors of appropriate audio devices.

They can receive up to 24-bit signals with sampling frequencies of 32–192 kHz.

### Use commercially available cables for connections.

COAXIAL: RCA coaxial digital cable

OPTICAL: optical digital cable (TOS)

## D Analog audio output connectors

These output 2-channel analog audio. Connect the XLR or RCA connectors to an amplifier.

### Use commercially available cables for connections.

XLR : balanced XLR cables

RCA : RCA audio cables

Connect this unit's R connector to the R connector of the amplifier, and its L connector to the L connector of the amplifier.

- Analog audio output can be set to either the RCA or XLR connectors (the XLR polarity can be set for pin 2 or 3 HOT) or OFF (see p.27).
- When the XLR connector is selected, the output level can also be set (see p.27).  
If distortion occurs when the output level is set to +6 dB, set it to 0 dB.

## E Clock sync input connector

Used to input an external clock signal.

Connect the clock sync input connector to the output connector of a master clock generator.

- The frequencies that can be input are 44.1 kHz, 88.2 kHz, 176.4 kHz, 10 MHz and 22.5792 MHz.

### Use a commercially available BNC coaxial cable for connection.

## F Ground connector [SIGNAL GND]

The audio quality may sometimes be improved by connecting this ground connector to an amplifier or other audio device that is connected to this unit.

- This is not a safety ground.

## G AC power inlet

Connect the included power cord to this inlet.

After all other connections have been completed, connect the power plug to the AC power outlet.

**⚠ Do not use any power cord other than an authentic Esoteric product. Doing so could cause fire or electric shock.**

**When the unit is not used for an extended period of time, disconnect the power plug from the outlet.**

At Esoteric, we use **Esoteric MEXCEL stressfree 7N** cables for reference. The following types of cables in the Esoteric **MEXCEL** cable series are available for purchase.

RCA audio cable

XLR audio cable

RCA digital cable

XLR digital cable

BNC digital cable

Speaker cable

Power cable

## Names and functions of parts (main unit)

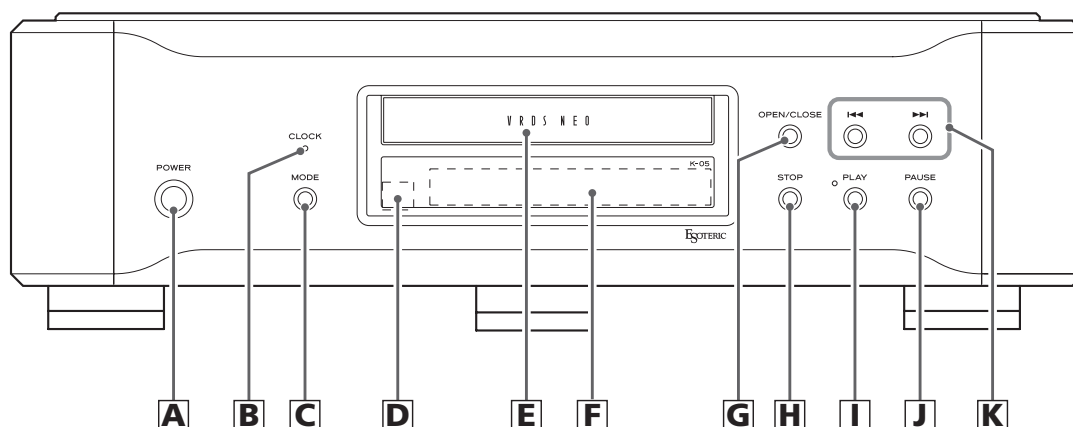

### **A** POWER button

Press to turn the power on and off.  
When the power is on, the ring around the button lights blue.  
When the power is off, the ring is unlit.  
When not using the unit, turn its power off.

### **B** CLOCK indicator

This shows the clock sync status.  
The indicator flashes when a signal is input through the clock sync input connector and stays lit when locked.

### **C** MODE button

Press when stopped to select disc playback or an external input as the source. When set to external input, the unit can be used as a D/A converter (see p.21).  
Press and hold for 2 or more seconds to change to setting mode (see p.24).

### **D** Remote control signal receiver

This receives signals from the remote control. When using the remote control, point the end of it toward this receiver panel (see p.9).

### **E** Disc tray

Load a disc for playback here (see p.16).

### **F** Display

This shows playback time, track number and other information (see p.13).

### **G** Tray OPEN/CLOSE button

Press to open and close the disc tray.

### **H** STOP button

Press to stop playback (see p.17).  
Press and hold when stopped for more than 2 seconds to change the playback area of a Super Audio CD (see p.17).  
Press while in setting mode to finish making settings. The CD status message appears on the display. (see p.24).

### **I** PLAY button

Press to start disc playback (see p.16).  
During playback, the PLAY indicator lights.

### **J** PAUSE button

Press to pause playback (see p.17).  
When paused, the PLAY indicator flashes.

### **K** Skip buttons (◀◀/▶▶)

Skip forward or backward.  
During playback, press and hold for 1 or more seconds to search forward/backward. Press and hold repeatedly for 1 or more seconds to change the search speed between 3 levels (see p.18).  
Use these when in setting mode to change parameters (see p.24).

## Names and functions of parts (display)

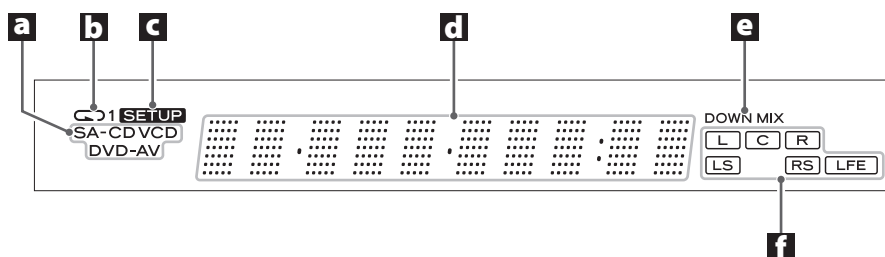

### **a** Disc indicator

This shows the type of disc that is loaded.

Super Audio CD: SA-CD  
Standard audio CD: CD

- If a DVD-Video (DVD-V), DVD-Audio (DVD-A) or video CD (VCD) is loaded, the indicator will light, but the disc cannot be played back.

### **b** Repeat indicator (↺)

This appears during repeat playback (see p.19)

### **c** SETUP indicator

This appears when in setting mode (see p.24).

### **d** Message display area

This shows the playback time and a variety of messages.

### **e** DOWN MIX indicator

When playing back the multichannel audio of a Super Audio CD, it is downmixed and output as stereo audio (2 channels). The DOWN MIX indicator lights at such times.

### **f** Channel indicator

L and R light during stereo audio (2-channel) playback.  
During multichannel audio playback, the indicators that correspond to the recorded channels light.

## Names and functions of parts (remote control)

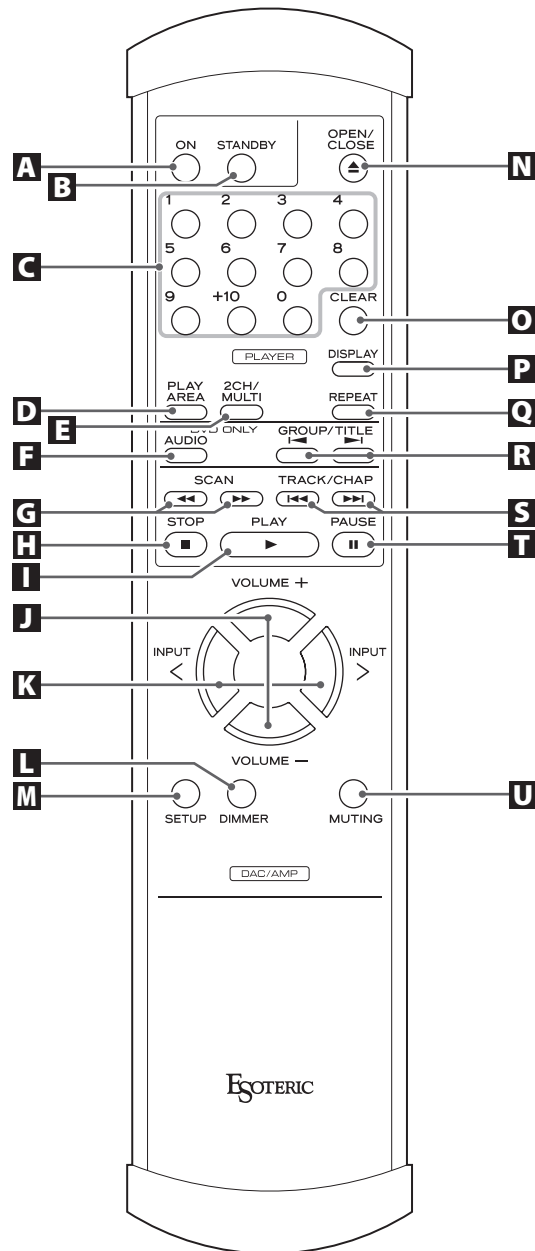

When the main unit and the remote control both have buttons with the same functions, this manual explains how to use the button on the main unit. The corresponding remote control button can be used in the same manner.

## **A** ON button

This button is not used with this unit.

## **B** STANDBY button

This button is not used with this unit.

## **C** Number buttons

Use to select tracks.

## **D** PLAY AREA button

Press when stopped to change the Super Audio CD play area (see p.17).

## **E** 2CH/MULTI button

This button is not used with this unit.

## **F** AUDIO button

Use with program playback (see p.20).

## **G** SCAN buttons (◀◀/▶▶)

Use to search forward/backward (see p.18).

## **H** STOP button (■)

Press to stop playback (see p.17).

## **I** PLAY button (▶)

Press to start disc playback (see p.16).

## **J** VOLUME buttons

When the attenuator function has been turned on in setting mode, these can be used to adjust the volume (see p.26).

Use these to adjust the volume of an Esoteric amplifier.

## **K** INPUT buttons

When stopped, press these buttons to switch between disc playback and external input sources. When set to external input, the unit can be used as a D/A converter (see p.21).

Use this to change the input of an Esoteric amplifier.

## **L** DIMMER button

Use to adjust the brightness of the main unit's display (see p.28).

## **M** SETUP button

If the attenuator function has been set to ON, pressing this button enters setting mode. This has the same function as pressing and holding the MODE button for 2 or more seconds (see p.24).

This button is disabled when the attenuator function has been set to OFF in setting mode.

Use to make Esoteric amplifier settings.

## **N** OPEN/CLOSE button (▲)

Press to open and close the disc tray (see p.16).

## **O** CLEAR button

Use this button to remove a number you have input by accident.

## **P** DISPLAY button

During playback, press this button to change what is shown on the display (see p.21).

## **Q** REPEAT button

Use with repeat playback (see p.19).

## **R** GROUP/TITLE buttons (|◀/▶|)

These buttons are not used with this unit.

## **S** TRACK/CHAP buttons (|◀◀/▶▶|)

Press to skip to the previous or next track (see p.18).

They are also used when in setting mode to change parameters (see p.24).

## **T** PAUSE button (||)

Press to pause playback (see p.17).

## **U** MUTING button

When the attenuator function has been turned on in setting mode, use to temporarily mute the output (see p.29).

Use to mute an Esoteric amplifier.

# Playback

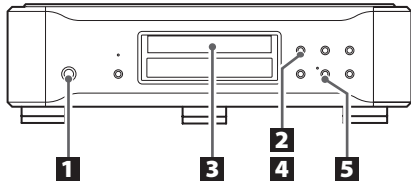

## 1 Turn the power on.



The ring around the POWER button lights blue.

## 2 Press the tray OPEN/CLOSE button.

The disc tray opens forward.



## 3 Place a disc on the center of the tray with its labeled-side up.

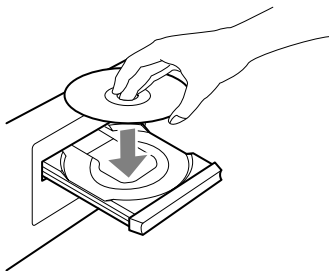

- If you close the tray when the disc is not within the central guides, the disc could become stuck inside and you might not be able to reopen the tray. For this reason, you should always place the disc carefully within the central guides.

## 4 Press the OPEN/CLOSE button.



The disc tray will close. Be careful not to let a finger or any item get caught in it.

- Disc-loading may take some time depending on the amount of information on the disc being loaded. When the disc is loaded, the type of disc, the number of tracks it contains and the total time of those tracks will appear on the display (see p.13).

## 5 Press the PLAY button.

Playback will start.



During playback, the PLAY indicator will light blue.

---

## Pausing playback

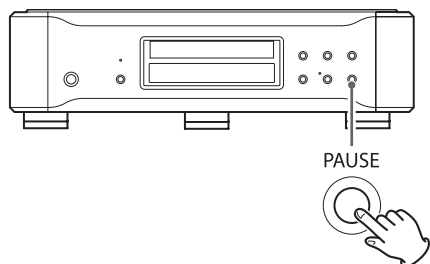

During playback, press the PAUSE button to pause playback. When paused, the PLAY indicator on the main unit flashes.

Press the PLAY button or press the PAUSE button again to restart playback.

---

## Opening and closing the disc tray

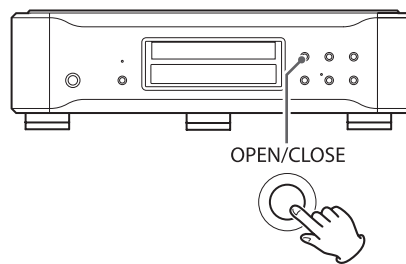

Press the OPEN/CLOSE button once to open the tray, and press it again to close the tray.

- If you press the OPEN/CLOSE button during disc playback, several seconds will pass before the tray opens.

---

## Stopping playback

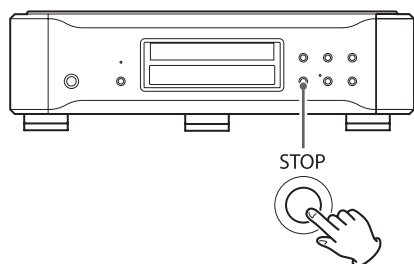

Press the STOP button to stop playback.

---

## Changing the play area

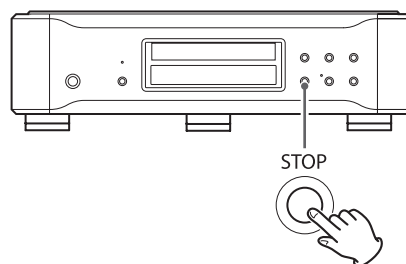

Some Super Audio CDs have multiple areas, including stereo (2-channel) and multichannel. Hybrid Super Audio CDs have two layers with one containing ordinary CD-quality audio. Press the STOP button for 2 or more seconds when the unit is stopped to change the play area.

- To change the play area using the remote control, press the PLAY AREA button when the unit is stopped.

# Selecting tracks

## Searching forward/backward (scanning)

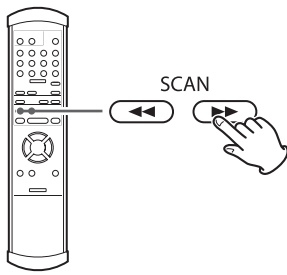

During playback, press a remote control SCAN button (◀◀/▶▶) to search forward/backward. When you find the point that you want to listen to, press the PLAY button (▶).

Press the SCAN button (◀◀/▶▶) repeatedly to change the search speed.

When using the main unit, press and hold (for more than 1 second) a skip button (◀◀/▶▶) repeatedly.

The speed that the < or > flashes on the display also changes.

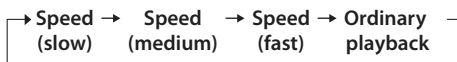

- To change the search forward/backward speed with a SCAN button (◀◀/▶▶), do not press and hold it. Press it again briefly to increase the speed.

## Skipping

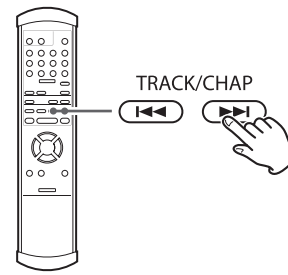

During playback, press a skip button (◀◀/▶▶) on the main unit or the remote control to skip to the previous or next track and start playback.

- Press the ◀◀ button once to return to the beginning of the track that is currently playing. Press the ◀◀ button repeatedly to skip to an earlier track. If you press the ◀◀ button when still within the first second of a track, however, you will skip to the previous track.
- When stopped or paused, press a skip button (◀◀/▶▶) to pause at the beginning of the selected track.

## Using the number buttons to select and play tracks

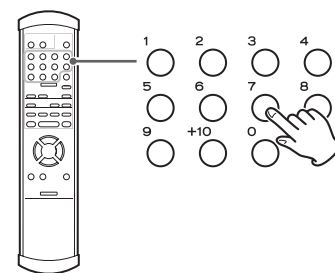

During playback or when stopped, press the number buttons to select a track and start its playback.

Examples:



Track 7

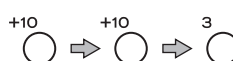

Track 23

## Using repeat playback

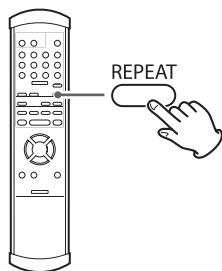

During playback, press the REPEAT button to cycle through the following repeat modes.

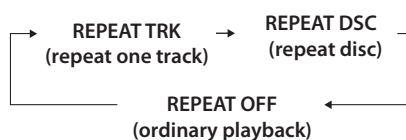

### REPEAT TRK

Repeats playback of the currently playing track. During repeat playback, if you select a different track, that track will begin playing back repeatedly.

### REPEAT DSC

Repeats playback of all the tracks on the currently playing disc.

- Stopping playback disables repeat playback.

## Using program playback (1)

You can program up to 30 tracks in the order that you want to listen to them.

### 1 Press the AUDIO button when stopped or during playback.

If a track is playing, it will become the first track in the program.

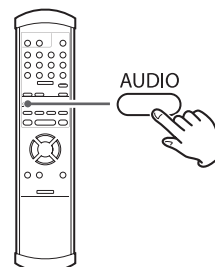

### 2 Use the number buttons to select a track that you want to add to the program.

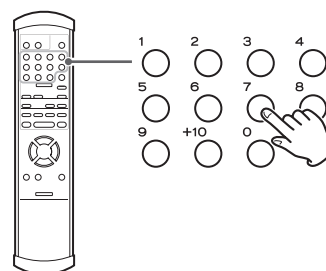

Examples

Track 3: 3

Track 12: +10 → 2

Track 20: +10 → +10 → 0

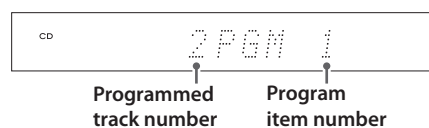

Continue using the number buttons to program multiple tracks.

- If you press the wrong number key, press the CLEAR button to remove the last track added to the program.
- Track numbers that do not exist on the currently loaded disc cannot be added to the program.

## Using program playback (2)

### 3 When you have finished adding tracks to the program, press the PLAY button (▶).

Program playback starts.

- If you created the program during playback, you do not need to press the PLAY button (▶).

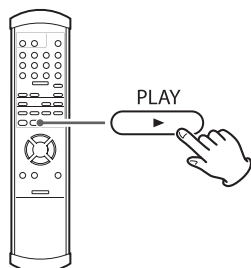

### Removing the last added track from the program

When stopped or during playback, press the CLEAR button to remove the last added track from the program. You can use the number buttons again to add another track.

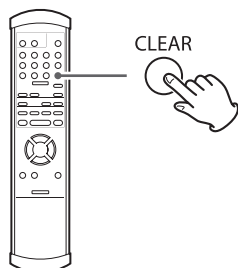

### Adding a track to the end of the program

When stopped or during playback, use the number buttons to select the number of the track that you want to add.

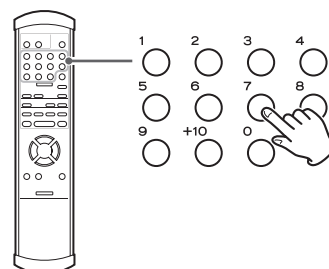

### Clearing the contents of the program and returning to ordinary playback

When stopped or during playback, press the AUDIO button to end program mode. Press the AUDIO button during program playback to resume ordinary playback from then on.

- This will clear the program contents.

In addition, when stopped or during playback, if you press the OPEN/CLOSE button (▲) or main unit power button, the program contents will also be cleared.

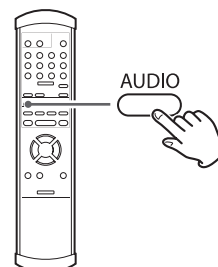

## Changing the display

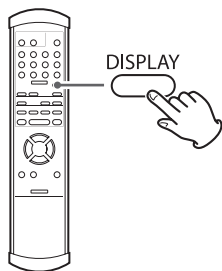

When a disc is playing or paused, press the DISPLAY button to change what is shown on the display in the order shown below.

Example:

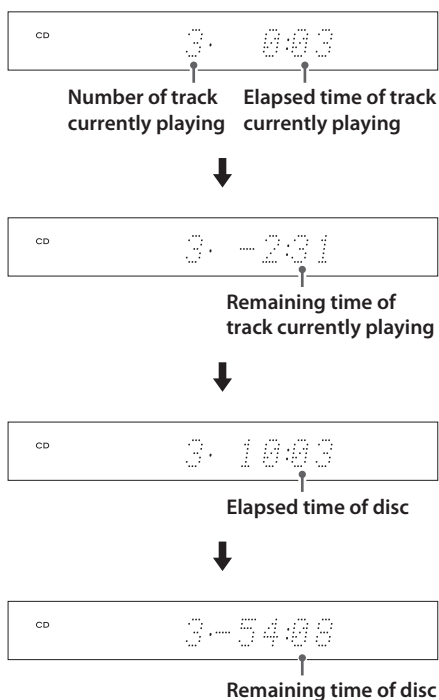

- When stopped, the total number of tracks and the total playback time of the disc are shown.

Example:



## D/A converter mode

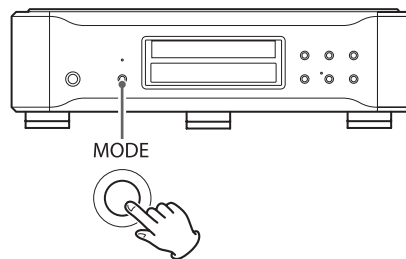

This unit can be used as D/A converter.

When stopped, press the MODE button to show the current source name. Press the MODE button again to switch between the following sources. Select one of the external digital inputs (COAX in, OPT in, USB in).

To do this using the remote control, press the INPUT button when stopped.

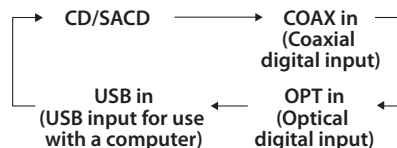

- When an external input (COAX in, OPT in, USB in) is selected, the name and sampling frequency of the selected input appears on the display. If there is no input signal or the input signal is not locked, the input sampling frequency is not shown and the input name flashes.
- If the input signal is not a digital audio signal or is an audio signal format that is not supported by this unit, including Dolby Digital, dts and AAC, for example, "----" appears in place of the sampling frequency. Set the digital output of the connected equipment to PCM audio output.
- When an external input (COAX in, OPT in, USB in) is selected, disc controls other than the OPEN/CLOSE button cannot be used.

# Connecting a computer and playing back audio files

By connecting this unit's USB input connector using a USB cable with a computer, you can play back audio files stored on a computer using this unit's D/A converter.

This unit can be connected by USB to computers that use the following operating systems.

Windows XP 32-bit  
Windows Vista 32/64-bit  
Windows 7 32/64-bit  
Mac OS X 10.6.4 or later

Operation with other operating systems cannot be guaranteed.

- Depending on the computer hardware and software integration, proper operation might not be possible even with the above operating systems.
- To connect in HIGH SPEED 1 or HIGH SPEED 2 mode, you must install dedicated driver software beforehand.  
If you connect this unit with a computer before installing the driver, it will not function properly. In addition, if you are using Windows XP, computer operation might become noticeably slower, and you might need to restart the computer.

Website address for driver software download

[http://www.esoteric.jp/products/esoteric/usb/usb\\_driver\\_e.html](http://www.esoteric.jp/products/esoteric/usb/usb_driver_e.html)

Install the dedicated driver software after downloading the file from the above address.

You can select 1 of 3 modes to use when connecting this unit to a computer by USB. See pages 24 to 27 for information about how to make settings.

## NORMAL mode

In setting mode, select USB>NOR.

This connects to the computer in FULL SPEED mode.

The sampling frequencies that can be transmitted are 32, 44.1, 48, 88.2 and 96 kHz. There is no need to install dedicated driver software when connecting this unit with a computer in order to use this mode. The unit and the computer will be connected using the standard USB audio driver.

- The first time that you connect this unit with a computer, the computer will automatically detect this unit's USB port and install the driver. Follow the instructions from the operating system. After completing driver installation, start the audio file playback application.  
If the proper connection has been made, you should be able to select "ESOTERIC USB AUDIO" as the audio output.

## HIGH SPEED 1 mode

In setting mode, select USB>HS\_1.

This connects to the computer in HIGH SPEED mode.

The sampling frequencies that can be transmitted are 32, 44.1, 48, 88.2, 96, 176.4 and 192 kHz. You must install dedicated driver software in order to use this mode when connecting this unit with a computer.

Download the dedicated driver software from our website.

If the proper connection has been made, you should be able to select "ESOTERIC USB HS AUDIO" as the audio output.

## HIGH SPEED 2 mode

In setting mode, select USB>HS\_2.

This connects to the computer in HIGH SPEED asynchronous mode.

The sampling frequencies that can be transmitted are 32, 44.1, 48, 88.2, 96, 176.4 and 192 kHz. You must install dedicated driver software in order to use this mode when connecting this unit with a computer.

Download the dedicated driver software from our website.

If the proper connection has been made, you should be able to select "ESOTERIC USB HS ASYNC AUDIO" as the audio output.

In asynchronous mode, the audio data sent from the computer will be processed using this unit's clock, enabling the amount of jitter that occurs during data transmission to be reduced.

- When using HIGH SPEED 2 mode to connect the computer with this unit, if the playback sound skips or noise occurs at regular intervals, use HIGH SPEED 1 mode instead.
- If you want to use HIGH SPEED 1 or HIGH SPEED 2 mode, install the dedicated driver software before connecting the unit with the computer (see p.22).

## 1 Connect this unit to a computer using a USB cable.

Use a cable with a connector that matches that of this unit.

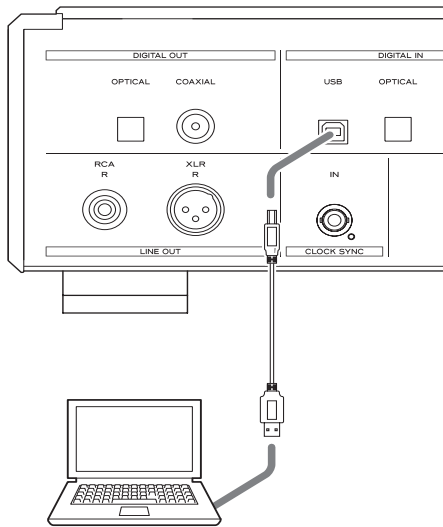

## 2 Turn the computer power on.

Confirm that the operating system has started properly.

## 3 Press the POWER button to turn this unit on.



## 4 Press the MODE button repeatedly to select USB (see p.24).

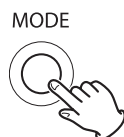

## 5 Start playback of an audio file on the computer.

Better sound quality can be achieved by setting the volume on the computer to the maximum level and using the amplifier connected to this unit to adjust the volume. Set the amplifier volume to the minimum when you start playback and gradually increase it.

- The computer cannot control this unit, nor can this unit control the computer.
- This unit cannot send audio files to the computer by USB.
- Do not do any of the following when playing back an audio file via USB. Doing so could cause the computer to malfunction. Always quit the music playback software before doing any of the following.
  - Unplug the USB cable
  - Turn this unit's power off
  - Change the input
- When playing back an audio file via USB, computer operation sounds will also be output. If you do not want these sounds to the output, make appropriate settings on the computer to turn them off.
- If you connect this unit with the computer or change its input to "USB" after starting the music playback software, audio files might not play back correctly. If this should occur, restart the audio playback software or restart the computer.

# Setting mode (1)

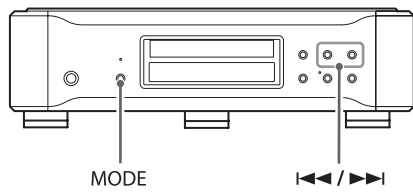

## Changing settings

**1** When stopped or during playback, press and hold the MODE button for 2 or more seconds.

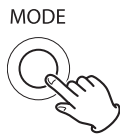

**2** Press the MODE button repeatedly to select different setting items.

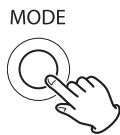

Each time you press the MODE button, the display will change.

- The items shown will differ according to the source currently selected (see p.21).

### CD/SACD source

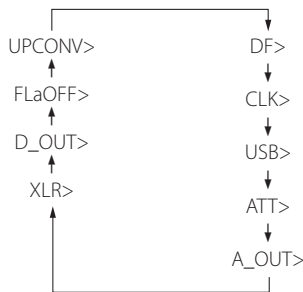

- The XLR item will only appear when the analog output (A\_OUT) setting is XLR2 or XLR3.

### COAX in or OPT in source

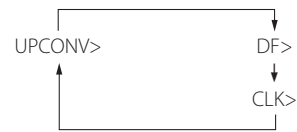

### USB source

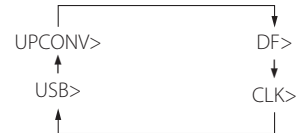

- Depending on the operation status, some items might not appear.
- Setting mode will end automatically if nothing is done for 10 seconds, and the CD status message will reappear.
- When the menu is open, if you press and hold the MODE button for 2 or more seconds, or you press the stop button once, setting mode will end and the CD status message will reappear.

**3** Use the main unit or remote control skip buttons (I<<</>>>I) to change settings.

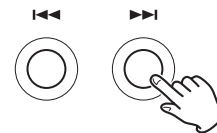

To change multiple items, repeat steps **2** and **3**.

**4** Press and hold the MODE button for 2 or more seconds to end setting mode.

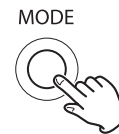

Setting mode will also end and the CD status message will reappear if nothing is done for 10 seconds or the stop button is pressed once.

- Setting changes will be retained even if the power plug is disconnected for an extended period of time.

## Upconversion setting

**Display: UPCONV>\*\*\***

- This setting can be made for each input.
- During Super Audio CD playback, the DSD signal is sent directly to the D/A converter.

### **ORG (original)**

The original input signal is sent directly to the D/A converter without upconversion.

### **2Fs**

32kHz, 44.1kHz and 48kHz sources are upconverted to double values of 64 kHz, 88.2 kHz and 96 kHz, respectively, and then sent to the D/A converter.

### **4Fs**

32kHz, 44.1kHz, 48kHz, 88.2kHz and 96kHz sources are upconverted to double or quadruple values of 128 kHz, 176.4 kHz or 192 kHz and then sent to the D/A converter.

### **DSD**

The signal is converted to DSD digital format, and then sent to the D/A converter.

## D/A converter digital filter setting

**Display: DF>\*\*\*\*\***

- This setting can be made for each input.
- During Super Audio CD playback or during conversion to DSD format, this is automatically set to the dedicated DSD filter.

### **OFF**

No digital filter is used by the D/A converter.

- Using this setting, high-frequency harmonic components will be output. If noise occurs because of cross modulation from high-frequency harmonic components, for example, set "DF" to "FIR" or "S\_DLY" instead.

### **FIR1**

The cutoff frequency of the FIR-type filter varies according to the input sampling frequency.

### **FIR2**

Regardless of the input sampling frequency, a FIR-type filter with a cutoff frequency of about 80 kHz is used.

### **S\_DLY1**

The cutoff frequency of the S\_DLY-type filter varies according to the input sampling frequency.

### **S\_DLY2**

Regardless of the input sampling frequency, a DLY-type filter with a cutoff frequency of about 80 kHz is used.

## About the D/A converter digital filters

### **FIR-type digital filters**

This type of filter has an established reputation for sound quality and features tonal quality with both dense, rich sound reverberations and crisp sound transients.

### **S\_DLY-type digital filters**

This type of filter has no pre-echo in the impulse response and features natural sound attack and reverberation for a tonal quality that is close to the original.

## Setting mode (2)

---

### Clock setting

**Display: CLK>\*\*\***

- This setting can be made for each input.

---

#### When the input is CD/SACD or USB(HS\_2)

##### INT

The unit operates with the built-in crystal oscillator as the master clock.

##### W\_IN

The unit operates with clock sync.

Input a clock signal through this unit's clock sync input connector (see p.10).

- When the input is CD/SACD, the clock sync frequencies that can be input are 44.1 kHz, 88.2 kHz, 176.4 kHz and 10 MHz.
- When the input is USB, the clock sync frequencies that can be input depend on the source sampling frequency.
  - 44.1 kHz source:
    - 44.1 kHz, 88.2 kHz, 176.4 kHz, 10 MHz
  - 48 kHz source
    - 48 kHz, 96 kHz, 192 kHz, 10 MHz

##### MCK\_IN

Use to input an external master clock signal directly.

Input a master clock signal through this unit's clock sync input connector (see p.10).

- When the input is CD/SACD, the master clock sync frequency that can be input is 22.5792 MHz.
- When the input is USB (HS\_2), the master clock sync frequency that can be input depends on the source sampling frequency.
  - 44.1kHz source: 22.5792 MHz
  - 48kHz source: 24.576 MHz

---

#### When the input is COAX or OPT

##### PLL1

The built-in PLL circuit follows the input digital audio signal and generates master clock. Operation in response to a wide range of input clock frequencies is possible.

##### PLL2

The PLL circuit follows the input digital audio signal and, together with the built-in high-precision crystal oscillator, generates master clock. By using PLL circuits with different characteristics in 2 stages, audio signal transmission jitter is reduced.

- In order to increase the performance of the built-in high-precision crystal oscillator, it has been designed with a narrow frequency variation range. If the clock frequency of the incoming digital signal exceeds the tolerance of the built-in high precision crystal oscillator, synchronization will not be possible. In such cases, set the unit to PLL1 mode.
- When the input is USB (NOR) or USB (HS\_1), the unit enters PLL1 mode.

---

### Analog output attenuator settings

**Display: ATT>\*\*\***

- When set to ON, you can adjust the attenuation value using the remote control VOLUME buttons.
- When set to OFF, the remote control VOLUME and MUTING buttons are disabled. When using this unit together with an ESOTERIC amplifier, set this to OFF.

##### OFF

The VOLUME buttons cannot be used.

##### ON

The VOLUME buttons can be used to adjust the volume between -99 dB and 0 dB (in 1 dB steps).

---

## USB input setting

### Display: USB>\*\*\*

- When set to use a HIGH SPEED mode, dedicated driver software must be installed on the computer. Download the driver software from our website.

#### NOR

Connect using USB FULL SPEED mode.  
The sampling frequencies that can be input are 32 kHz, 44.1 kHz, 48 kHz, 88.2 kHz and 96 kHz.

#### HS\_1

Connect using USB HIGH SPEED mode.  
The sampling frequencies that can be input are 32 kHz, 44.1 kHz, 48 kHz, 88.2 kHz, 96 kHz, 176.4 kHz and 192 kHz.

#### HS\_2

Connect using USB HIGH SPEED asynchronous mode.  
The sampling frequencies that can be input are 32 kHz, 44.1 kHz, 48 kHz, 88.2 kHz, 96 kHz, 176.4 kHz and 192 kHz.  
In asynchronous mode, the clock signal of this unit is used for playback of the audio data transmitted from the computer.

- If skipping noise occurs during playback when set to HS\_2, set the unit to HS\_1 instead

---

## Analog output setting

### Display: A\_OUT>\*\*\*\*

#### RCA

Analog audio signals are output through the RCA jacks.

#### XLR2

Analog audio signals are output through the XLR connectors with pin 2 HOT.

#### XLR3

Analog audio signals are output through the XLR connectors with pin 3 HOT.

#### OFF

Analog outputs are disabled and the D/A converter is turned off.

---

## XLR output gain setting

### Display: XLR>\*\*\*\*

#### +6dB

Set the XLR output level to double the RCA output level (+6 dB).

#### 0dB

Set the XLR output level to the same level as the RCA output level (0 dB).

- This setting only appears when the analog output is set to XLR2 or XLR3.
- If the sound clips when set to "+6dB", change the setting to "0dB".
- Depending on the connected amplifier, either the "+6dB" setting the "0dB" setting might result in the same volume as the RCA jack input.

---

## Digital output setting

### Display: D\_OUT>\*\*\*

- During Super Audio CD playback, this is automatically set to off.

#### ON

Turns the digital output on.

#### OFF

Turns the digital output off.

## Setting mode (3)

### Automatic display (FL) off setting

#### Display (FLaOFF>\*\*\*)

##### 15m

In CD/SACD mode, if playback is stopped and no operation is conducted for 15 minutes, the display automatically turns off.

In D/A converter mode, after input has been locked for at least 15 minutes, the display automatically turns off.

##### 30m

In CD/SACD mode, if playback is stopped and no operation is conducted for 30 minutes, the display automatically turns off.

In D/A converter mode, after input has been locked for at least 30 minutes, the display automatically turns off.

##### 60m

In CD/SACD mode, if playback is stopped and no operation is conducted for 60 minutes, the display automatically turns off.

In D/A converter mode, after input has been locked for at least 60 minutes, the display automatically turns off.

##### OFF

The display never turns off automatically.

- If the display is left ON with the same indication for a long time, brightness irregularities can occur. For this reason, we recommend that you enable the automatic display off function.

## Using the dimmer

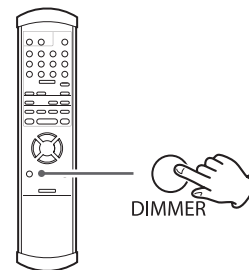

You can change the brightness of the display and indicators on the main unit.

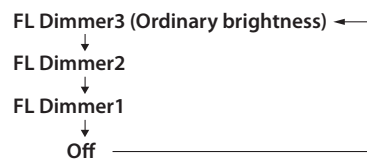

- If you select "Off", the display and the indicators will be unlit.
- In off mode, when you press PLAY or another button, the display will light at normal brightness for several seconds.
- Even if set to a brightness other than Dimmer 3, when an error message is shown or the unit is in setting mode, the display will light with ordinary brightness (Dimmer 3).

## Adjusting the volume

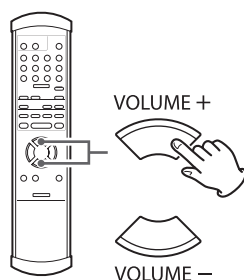

You can adjust the volume of the analog audio outputs with this unit. This is convenient when connecting the unit directly to a power amplifier without a pre-amplifier.

- Set the attenuator to ON (see p.26).

Press the remote control VOLUME + button to increase the volume, and the - button to decrease it. The volume can be adjusted in 1 dB steps (-99 dB to 0 dB).

---

## Muting the output

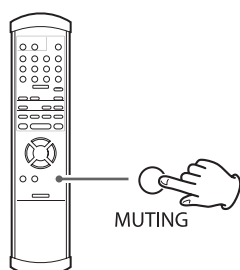

Press the remote control MUTING button to temporarily mute the sound. Press again to restore the previous volume setting.

- This can only be used when the attenuator function is set to ON (see p.26).

### CAUTION

**The volume setting is retained even when the power is turned off. Always minimize the volume of this unit before turning on a connected power amplifier.**

**Never connect this unit directly to a power amplifier when the attenuator is set to OFF. Doing so could cause the output of sudden loud sounds resulting in harm to hearing and speaker damage.**

## Troubleshooting (1)

If you experience a problem with the unit, please take a moment to review the following information before requesting service. Moreover, the problem might be caused by something other than this unit. Confirm that connected devices are also being used correctly.

### General

#### The power does not turn on.

- ➔ Insert the power plug into an outlet.
- ➔ Check the connection of the power cord to this unit.

#### Remote control does not work.

- ➔ Turn the main unit power on (see p.16).
- ➔ If the batteries are exhausted, replace both of them with new ones (see p.9).
- ➔ The remote control will not work if there is an obstacle between it and the main unit. Point the remote control toward the main unit and use it within 7 m of the front panel (see p.9).

#### A television or other device is operating improperly.

- ➔ Some televisions with remote control functions might be made to operate improperly by this unit's remote control.

#### Cannot play back a CD or Super Audio CD.

- ➔ Press the MODE button repeatedly to select "CD/SACD" (see p.21).
- ➔ Load the disc correctly. If the disc is turned over, reload it with its labeled side up.
- ➔ If the disc is dirty, wipe it clean (see p.8).
- ➔ If there is condensation inside the unit, turn the power on and leave it alone for one or two hours (see p.7).

#### Unit does not respond to button presses.

- ➔ The unit cannot always respond to multiple button presses in a short amount of time. Wait a moment for the unit to complete the operation after pressing a button.

#### There is noise.

- ➔ Place the unit is far away as possible from televisions and other devices with strong magnetism.

#### No sound from speakers or sound is distorted.

- ➔ Check the connections with the amplifier and speakers (see p.10).
- ➔ Adjust the volume of the amplifier and other devices.
- ➔ If the disc is dirty, wipe it clean (see p.8).
- ➔ Super Audio CD digital audio cannot be output from the digital audio output connectors.
- ➔ No sound is output when playback is paused. Press the PLAY button to resume playback.
- ➔ Check the analog audio output setting (see p.27).

#### Digital recording is not possible on connected external equipment.

- ➔ You cannot record the digital audio signal as is from a disc that has copy-protection.

#### Noticeable difference in volume between CDs and Super Audio CDs.

- ➔ You might notice volume differences between ordinary CDs and Super Audio CDs. This is the result of differences between their data recording methods, mastering and authoring.

## Troubleshooting (2)

### Clock sync

#### **“NO WORD!” appears on the display.**

- ➔ No clock signal is being input. Check the connection with the external master clock generator and its power and output status.
- ➔ If clock cannot be input, set the clock to INT. (see p.26).

#### **“WRD UNLCK!” appears on the display.**

- ➔ Synchronization with the signal being input might not be possible. Check the clock sync input connector connection and the settings of the connected equipment.  
The input frequencies that this unit can accept are 44.1 kHz, 88.2 kHz, 176.4 kHz, 10 MHz and 22.5792 MHz.

#### **“PLL ERROR!” appears on the display.**

- ➔ Since an audio signal is being input that exceeds the range that this unit's master clock can synchronize with, change the clock setting from PLL2 to PLL1.

### USB connections with a computer

#### **Computer does not recognize this unit.**

- ➔ This unit can be connected with computers running the following operating systems.
  - Windows XP 32-bit
  - Windows Vista 32/64-bit
  - Windows 7 32/64-bit
  - Mac OS X 10.6.4 or laterOperation with other operating systems cannot be guaranteed.

#### **Noise occurs.**

- ➔ Starting other applications during playback of a music file may interrupt playback or cause noise. Do not start other applications during playback.
- ➔ When the unit is connected to a computer via USB hub, for example, noise might be heard. If this occurs, connect the unit directly to the computer.

#### **Audio files cannot be played back.**

- ➔ Connect the computer and this unit and switch to “USB in” before starting the music playback software and starting playback. If you connect this unit and the computer after music playback software has already been started, the audio data might not be played back correctly after switching this unit's inputs to “USB in”.
- ➔ To use HIGH SPEED mode, you must install a dedicated driver (see pp.22–23).

**Since this unit uses a microcontroller, external noise and other interference can cause the unit to malfunction. If this occurs, turn the power off once, and then restart it after waiting for about one minute.**

# Specifications

## Compatible disc types (playback)

Super Audio CD, CD (including CD-R and CD-RW)

## Analog audio outputs

Connectors	XLR connector (2ch) × 1
	RCA connector (2ch) × 1
Output impedance	XLR: 100 Ω
	RCA: 25 Ω
Maximum output level (1 kHz, full-scale, into 10 kΩ)	XLR (set to 0 dB): 2.45 Vrms
	RCA: 2.45 Vrms
Frequency response	5 Hz to 55 kHz (-3 dB)
S/N ratio	115 dB
Total harmonic distortion	0.0015 % (1 kHz)

## Digital audio output

RCA connector × 1	0.5 Vp-p (into 75 Ω)
Optical digital connector × 1	-15 to -21 dBm

## Digital audio input

RCA connector × 1 (input impedance 75 Ω)	0.5 Vp-p
Optical digital connector × 1	-24.0 to -14.5 dBm peak
USB-B connector	USB2.0 standard

## Clock sync input format

Connector	BNC
Supported input frequencies	
CD/SACD	44.1, 88.2, 176.4 kHz, 10/22.5792 MHz
USB (HS_2) input	44.1, 48, 88.2, 96, 176.4, 192 kHz, 10, 22.5792, 24.576 MHz (±15 ppm)
Input impedance	75 Ω
Input level	Rectangle wave: equivalent to TTL levels Sine wave: 0.5 to 1.0 Vrms (50 to 75 Ω)

## General

Power supply	
Europe/Hong Kong model	AC 230 V, 50 Hz
U.S.A./Canada model	AC 120 V, 60 Hz
Korea model	AC 220 V, 60 Hz
Power consumption	13 W
External dimensions (W x H x D)	445 x 131 x 358 mm (17 1/2" x 5 1/8" x 14 1/8") (including protrusions)
Weight	14 kg (30 7/8 lb)
Operating temperature range	+5°C to +35°C
Operating humidity range	5 % to 85 % (no condensation)
Storage temperature range	-20°C to +55°C

## Included accessories

Power cord	× 1
Remote control (RC-1251)	× 1
Batteries for remote control (AA)	× 2
Owner's manual (this document)	× 1
Warranty card	× 1

Design and specifications are subject to change without notice. Illustrations in this manual might differ slightly from production models.

## Restoring factory default settings

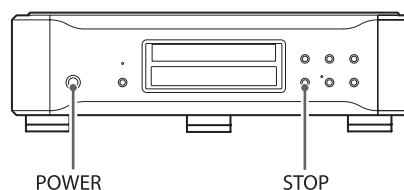

Setting changes are retained even when the power cord is disconnected.

Follow these procedures to make the unit forget setting changes and restore all settings to their factory defaults.

### 1. Turn the power off.

If the unit is on, press the POWER button to turn it off and wait for more than 30 seconds.

### 2. Press the POWER button while holding down the STOP button on the main unit.

Release the STOP button when "Setup CLR" appears on the display.

# Rear panel

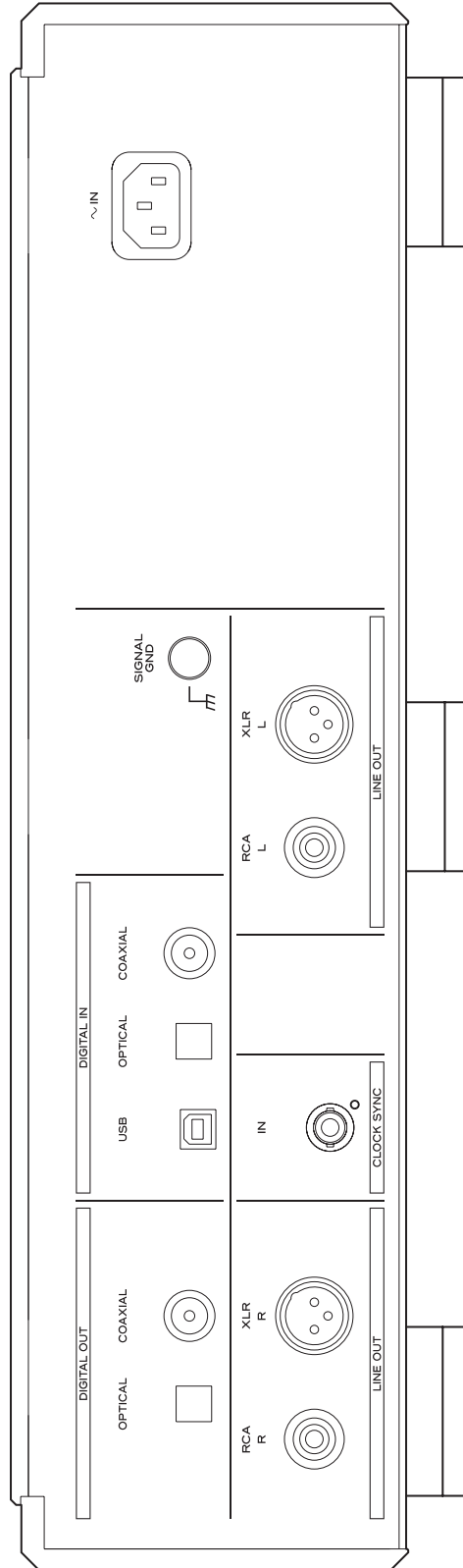







# ESOTERIC

---

TEAC CORPORATION	1-47 Ochiai, Tama-shi, Tokyo 206-8530, Japan Phone: (042) 356-9156 e-mail: eso-os@tec.teac.co.jp
TEAC AMERICA, INC.	7733 Telegraph Road, Montebello, California 90640 U.S.A. Phone: (323) 726-0303 e-mail: esoteric_info@teac.com
TEAC CANADA LTD.	5939 Wallace Street, Mississauga, Ontario L4Z 1Z8, Canada Phone: (905) 890-8008
TEAC MEXICO, S.A. de C.V.	Río Churubusco 364, Colonia Del Carmen, Delegación Coyoacán, CP 04100, México DF, México Phone: (5255)5010-6000
TEAC UK Ltd.	Suites 19 & 20, Building 6, Croxley Green Business Park, Hatters Lane, Watford, Hertfordshire, WD18 8TE, U.K. Phone: (0845) 130-2511
TEAC EUROPE GmbH	Bahnstraße 12, D-65205 Wiesbaden-Erbenheim, Deutschland Phone: 0611-71580

---

This appliance has a serial number located on the rear panel. Please record the serial number and retain it for your records.

Model name: K-05

Serial number \_\_\_\_\_

0112·MA-1781A